

Specification	
Nominal voltage	2 V
Capacity @ 25°C	522AH @ 120hr F.V. = 1,85 V/cell 440AH @ 24hr F.V. = 1,80 V/cell 359AH @ 10hr F.V. = 1,75 V/cell
Cell condition	Wet & Charged
Weight (dry)	17,5 kg ± 5%
Weight (wet)	23,5 kg ± 5%
Dimensions	
Width (A)	101 mm
Length (B)	198 mm
Height (H)	478 mm
Height (H ₁)	508 mm
Cell properties	
Container material	PP
Box / Lid color	Translucent / Blue
Terminal type / size	Bolt-on / M10
Separators	PE Envelope type
Vent Plug type	Push fit vent plug
Electrolyte s.g. at 25 °C	1.24 ± 0.005 g/cm ³ (fully charged)
Number of (+) / (-) plates	4 / 5

Characteristics	
Operating temp. range	Charge, discharge: 15 – 35°C Storage: 5 – 40°C
Cycle life @ 25°C	6000 cycles for 30% DoD 2600 cycles for 50% DoD 1550 cycles for 80% DoD
Charging Voltage / Current	Float : 2,40V ± 0,02 Vpc Boost : 2,50 ± 0,02 Vpc – I _{max} = 0,2 C ₁₀ I _{min} = 0,1 C ₁₀ Equalize : 2,30V ± 0,02 Vpc I _{max} = 25 A Time = 6 h
Capacity affected by temperature	105% at 35°C 100% at 25°C 88% at 0°C
Storage time	Max. 6 months at 25°C Max. 2 months at 30 °C Max. 1 month at 40°C
Applicable Standards	IEC 61427, IEC 60896 - 11

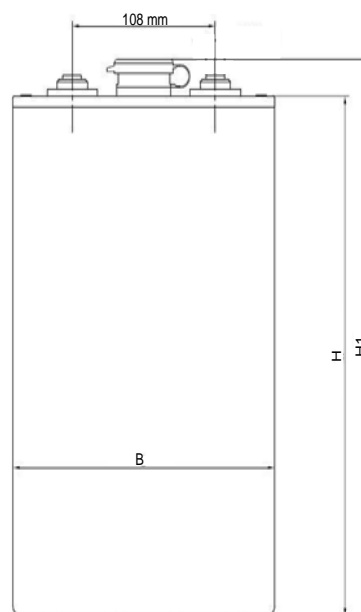
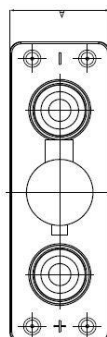
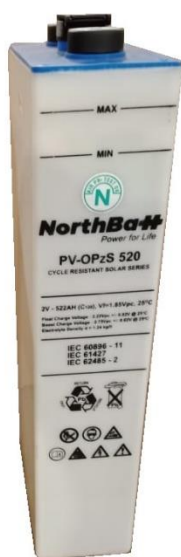

Performance Curves

Cycle Life vs D.o.D.

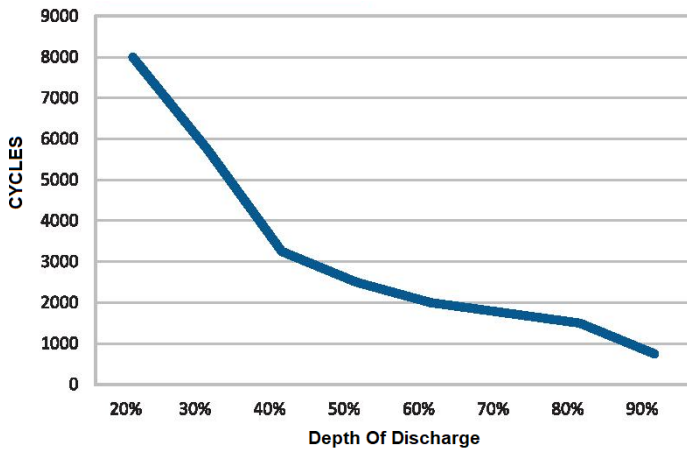

Lifetime vs Temperature

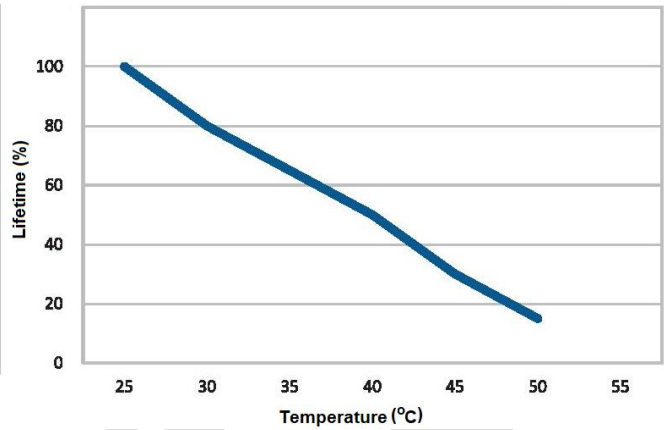

Float Voltage vs Temperature

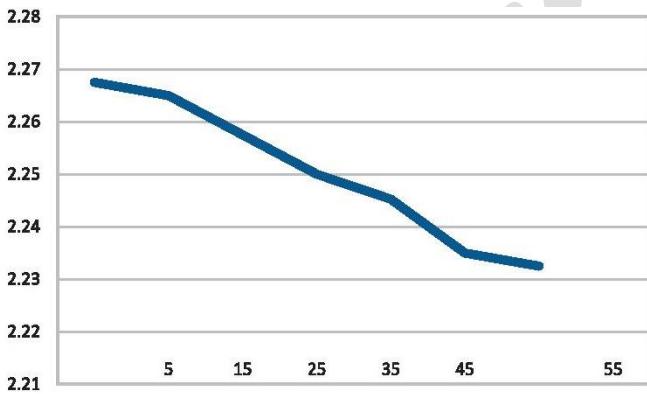

Performance vs Temperature

